

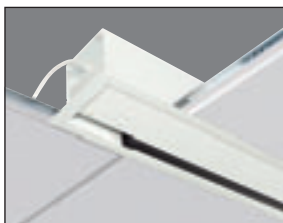

## Tensioned Descender Electrol

- Attractive and durable built-in solution with tab-tensioned system for a flat projection screen surface at all times. Building in a projection screen efficiently was never this easy.
- Easy Serviceability System: once installed, the motor and screen surface remain accessible making adjustments and carrying out maintenance possible. The bottom panel and case remain connected to each other.
- Easy to build into existing non-modular ceilings.
- The case and the projection screen surface can be made to exactly the right size and the case is available in any colour for optimal integration into any interior.
- Limit switches are factory set guaranteeing a long life span. The Tensioned Descender Electrol is supplied with a wall switch.
- The projection surface is extremely flat, making it suitable for all types of data and video projection.



Perfect integration into the ceiling



Slat bar retracts into the case



Easy Serviceability

### Available aspect ratios



### Available dimensions

Minimum width: 180 cm  
Maximum width: 340 cm

### Available screen surfaces

<b>Matte White</b> Gain: 1.0 Viewing Angle: 120°	<b>High Contrast Cinema Vision</b> Gain: 1.1 Viewing Angle: 100°	<b>Pearlescent</b> Gain: 1.5 Viewing Angle: 80°	<b>Da-Tex®</b> Gain: 1.3 Viewing Angle: 60°	
<b>HD Progressive 0.6</b> Gain: 0.6 Viewing Angle: 170°	<b>HD Progressive 0.9</b> Gain: 0.9 Viewing Angle: 170°	<b>HD Progressive 1.1</b> Gain: 1.1 Viewing Angle: 170°	<b>HD Progressive 1.3</b> Gain: 1.3 Viewing Angle: 150°	<b>HD Progressive 1.1 Perf</b> Gain: 1.1 Viewing Angle: 170°

### Other options

Radio frequency: Includes built-in radio frequency receiver, making it possible to operate the screen using the supplied remote control.



### Accessories



Easy Install Plug and Play Relay Box with Potential-Free Contacts

Easy Install Plug and Play RF Remote Control

Easy Install RF Wall-Mounted Transmitter

Easy Install RF Remote Control with Wireless Projector Coupling

BrightSight for safely cleaning the projection surface

Dimensions and product codes on



## 2-Step installation

### Screen Case / Screen Surface Assembly

- Order the screen case separate from the screen surface. Install the screen case during the rough-in stages and the Screen Surface Assembly at a later stage preventing any damage.
- The Screen Surface Assembly includes the bottom panel of the screen, motor and screen surface.
- The steel cables of the Projecta Easy Serviceability System easily connect the Screen Surface Assembly to the case ensuring a quick installation.
- Order the case first and decide the aspect ratio and screen surface at a later stage ensuring optimal flexibility.

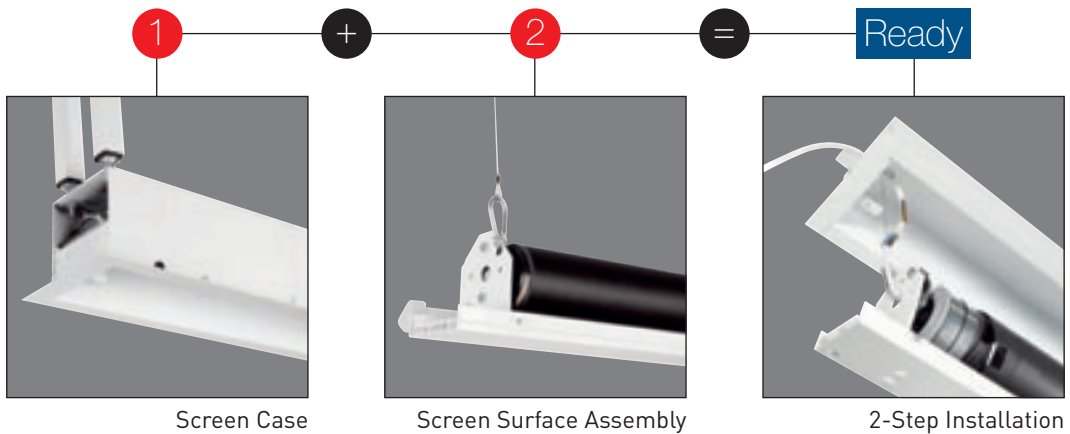
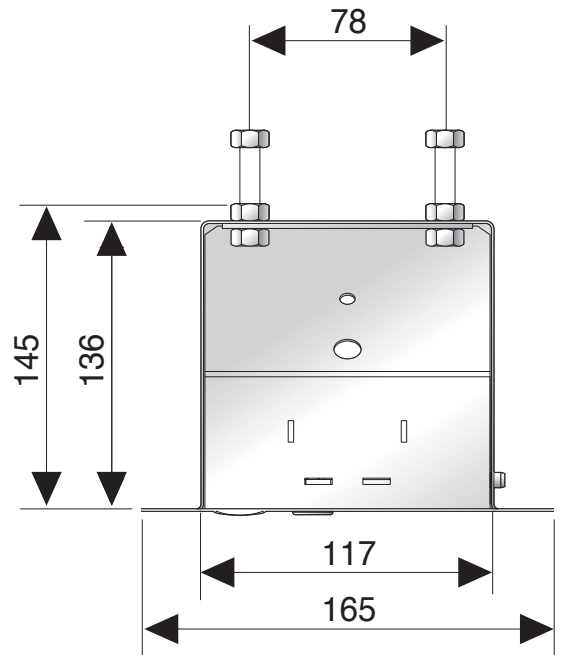

**Product:** Tensioned Descender Electrol **Installer:** Backstage AV B.V. **Location:** NEC Enterprise Solutions (Hilversum, The Netherlands)

